

2 BEDROOM FLOOR AND ELETRICAL LAYOUT

SCALE 1:50

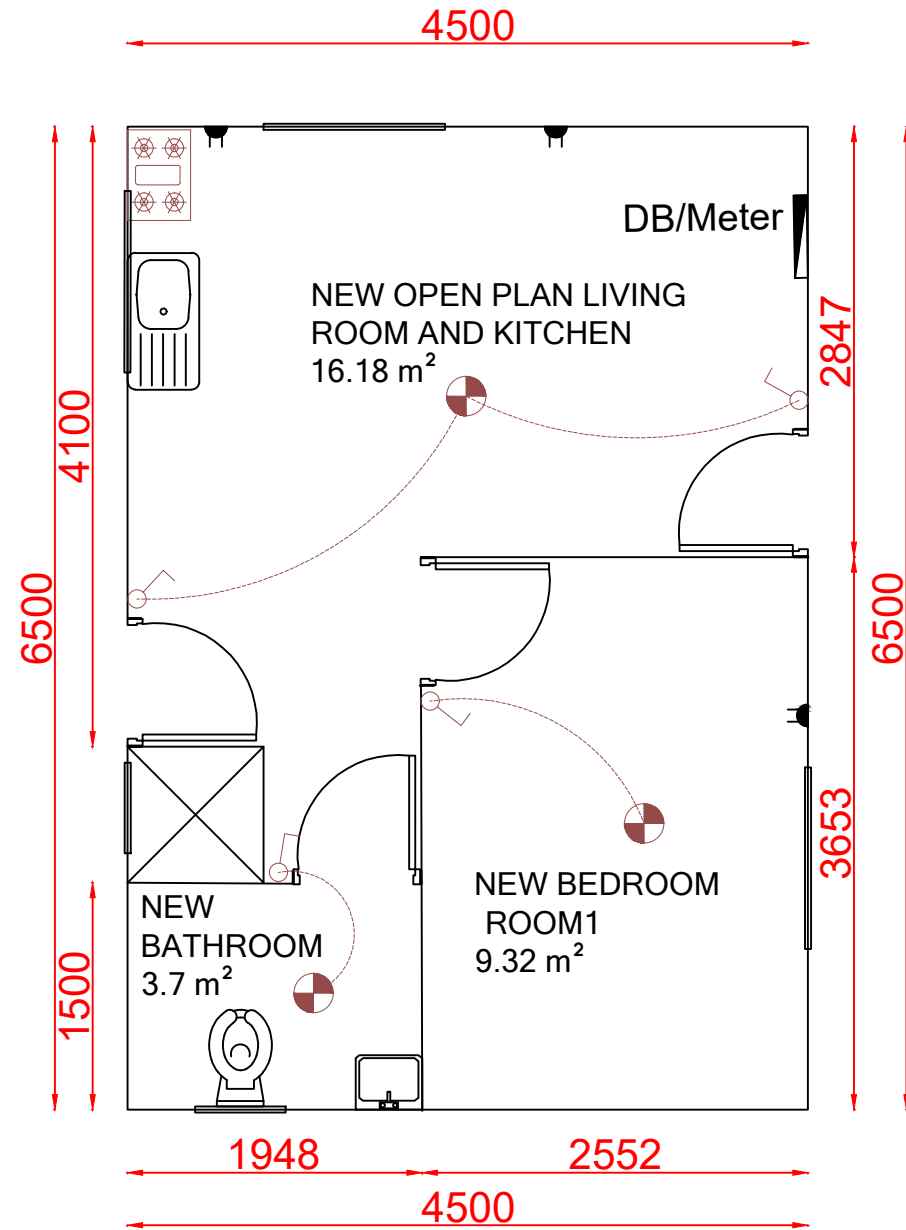
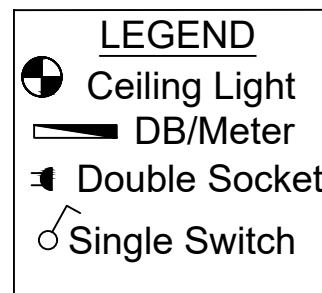

1 BEDROOM FLOOR AND ELETRICAL LAYOUT

SCALE 1:50

GENERAL NOTES

- ALL DIMENSIONS NEED TO BE CONFIRMED PRIOR TO CONSTRUCTION
- ALL MATERIALS AND WORKMANSHIP TO BE IN ACCORDANCE WITH THE LATEST EDITION OF SANS 1200
- CONCRETE** USING 19MM AGGREGATE, CONCRETE MIXES: BUILDING 15MPa, FOUNDATIONS-25MPa WITH 50mm CONCRETE COVER AND SURFACE BED 25MPa AND A CONCRETE COVER 50mm. PLASTER INTERNAL SMOOTH FINISH 13 MM THICK AND EXTERNAL WALL WOOD FLOAT FINISH 13 MM THICK.
- CONCRETE RAMP ALL AROUND STRUCTURES 50 MM THICK AND 500 MM FROM WALLS
- PREFAB PANELS TO BE COASTAL WEATHER FRIENDLY
- ROOF** - TO BE COASTAL WEATHER FRIENDLY.
- PAINTWORK** PREPARE ALL SURFACES AND PAINT ONE UNDERCOAT AND FINISH WITH TWO FINAL COATS.
- ALL FLOOR FINISHES, WALL TILES, BATHROOM AND KITCHEN SPECIAL FITTINGS TO BE AGREED BY OWNER.

TITLE: PREFAB UNITS

ORANJEMUND TOWN COUNCIL



DRAWN BY:
FRANKLIN KLAASTE

DRAWING NO:
FK-A3-0001

CHECKED BY:
MR. F NEKAYI

DATE:
21/12/2022

SHEET NO:1/1

SCALE:
INDICATED
ON PLAN